



SPLIT MURAL COOL PRO

Serie
COOL PRO DS 9-24 KKD

Edition
12/22

Models
DS-9KKD WIFI
DS-12KKD WIFI
DS-18KKD WIFI
DS-24KKD WIFI

Contents

Remote controller	1
Operation instructions.....	3
Operation modes	3
Airflow direction control.....	4
CLOCK button	5
Timer mode.....	5
SLEEP mode	6
Turbo mode	6
8°C HEAT mode.....	7
LOCK function	7
MUTE mode.....	8
ECO mode	8
IFEEL function	8

Remote controller

Remote controller

The remote controller transmits signals to the system.

- 1** **ON/OFF BUTTON**
The appliance will be started when it is energized or will be stopped when it is in operation, if you press this button.
- 2** **MODE BUTTON**
Press this button to select the operation mode.
- 3** **FAN BUTTON**
Used to select fan speed in sequence auto, high, medium or low.
- 4** **5** **ROOM TEMPERATURE SETTING BUTTONS**
Used to adjust the room temperature and the timer, also real time.
- 6** **TURBO BUTTON**
Used to start or stop the fast cooling. (Fast cooling operates at high fan speed with 16°C set temp automatically.)
- 7** **SWING BUTTON**
Used to stop or start vertical adjustment louver swinging and set the desired up/down airflow direction.
- 8** **SLEEP BUTTON**
Used to set or cancel Sleep Mode operation.
- 9** **LIGHT BUTTON**
When you press this button, all the display of indoor unit will be closed.
- 10** **CLOCK BUTTON**
Used to set the current time.
- 11+12** **TIMER ON/OFF BUTTON**
Used to set or cancel the timer operation.
- 13** **ECO BUTTON**
Used to set or cancel Economy Mode operation.
- 5+7** **8°C HEAT**
Press them together for 3 seconds to start or stop 8°C HEAT mode.

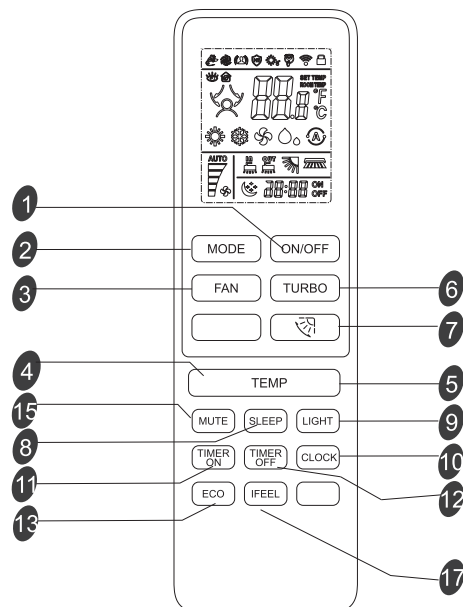

- 15** **MUTE BUTTON**
Press it once, the MUTE function will be started. Press it again, the MUTE function will be shut off. Use to set CLEAN mode operation.
- 17** **IFEEL BUTTON**
Used to set IFEEL mode operation. Press it once, the IFEEL function will be started. Press it again, the IFEEL function will be shut off. If the IFEEL function can't be shut off, please try to press this button about 5 seconds. Advice to put the remote controller in the place where the indoor unit receive signal easily. Advice to cancel the IFEEL mode so as to save energy when stopping the air conditioner.
- 11** **12** **LOCK**
Press them together for 3 seconds to start or stop LOCK operation.

Indication symbols on LCD:

- | | | | |
|--------------------|-------------------------------|-----------------------|--|
| Cooling indicator | Auto fan speed | Smart indicator | Signal transmit |
| Dry indicator | High fan speed | Sleep indicator | 28:08 ON Display set timer
OFF Display current time |
| Fan only indicator | Medium fan speed | 8°C Heating indicator | 88°C Display temperature |
| Heating indicator | Low fan speed | Economy indicator | Lock |
| Turbo indicator | Mute indicator | Ifeel | |
| | Airflow up and down indicator | | |

Note: Each mode and relevant function will be further specified in following pages.

Remote controller

Remote controller

• How to Insert the Batteries

Remove the battery cover according to the arrow direction.

Insert new batteries making sure that the (+) and (-) of battery are matched correctly.

Reattach the cover by sliding it back into position.

Note:

- Use 2 LR03 AAA (1.5volt) batteries. Do not use rechargeable batteries. Replace batteries with new ones of the same type when the display becomes dim.

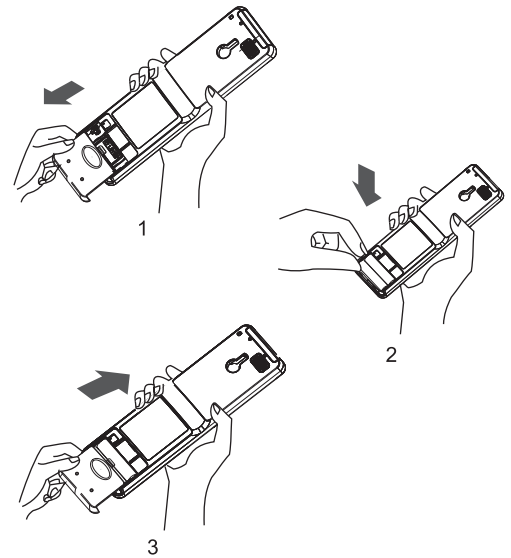

• Storage and Tips for Using the Remote Controller

The remote controller may be stored mounted on a wall with a holder.

Note: The remote controller holder is an optional part.

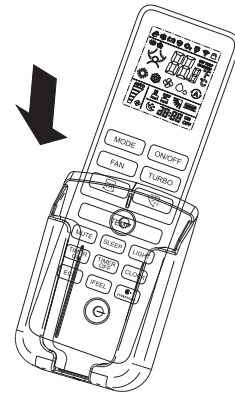
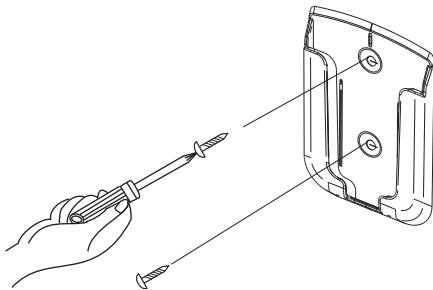

• How to Use

To operate the room air conditioner, aim the remote controller to the signal receptor. The remote controller will operate the air conditioner at a distance of up to 7m when pointing at signal receptor of indoor unit.

⚠ CAUTIONS

For appropriate signal transmission between remote controller and indoor unit, keep the signal receiver away from the following items:

- Direct sunlight or other strong lights or heat
- Flat panel television screen or other electrical appliances that react to the remote controller

Additionally, the air conditioner will not operate if curtains, doors or other materials block the signals from the remote controller to the indoor unit. If the signal may not be transmitted properly, either move these materials or consult your local dealer.

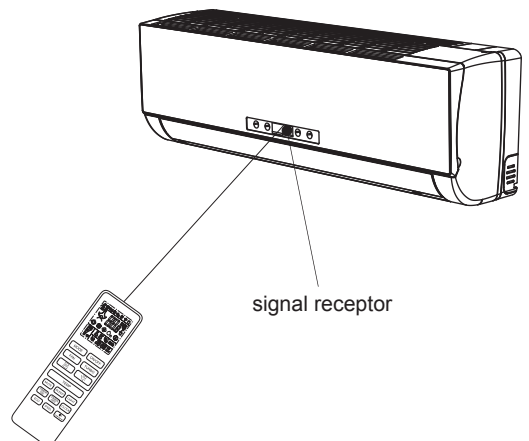

Operation instructions

Operation modes

Selecting mode

Each time the "MODE" button is pressed, the operation mode is changed in sequence:

COOLING → DRY → FAN ONLY → HEATING → AUTO

1

- ☑ Heating mode is NOT available for cooling only air conditioner.

FAN mode

Each time the "FAN" button is pressed, the fan speed is changed in sequence:

Auto → Higher → High → Medium → Low → Lower

2

- ☑ At "FAN ONLY" mode, only "Higher", "High", "Medium", "Low" and "Lower" are available. At "DRY" mode, Fan speed is set at "Auto" automatically, "FAN" button is ineffective in this case.

Setting temperature

- "+" Press once to raise temperature setting by 1°C
- "-" Press once to lower temperature setting by 1°C

3

☑	Range of available set temperature	
	*HEATING, COOLING	16°C-30°C

- Note: Heating mode is NOT available for cooling only models.**
- Note: Press and hold "MODE" button and "TEMP" button together for 3 seconds will alternate the temperature display together for 3 seconds will alternate the temperature display between the °C and °F scale.**

Turning on

Press ON/OFF button, when the appliance receives the signal, the RUN indicator of the indoor unit lights up.

4

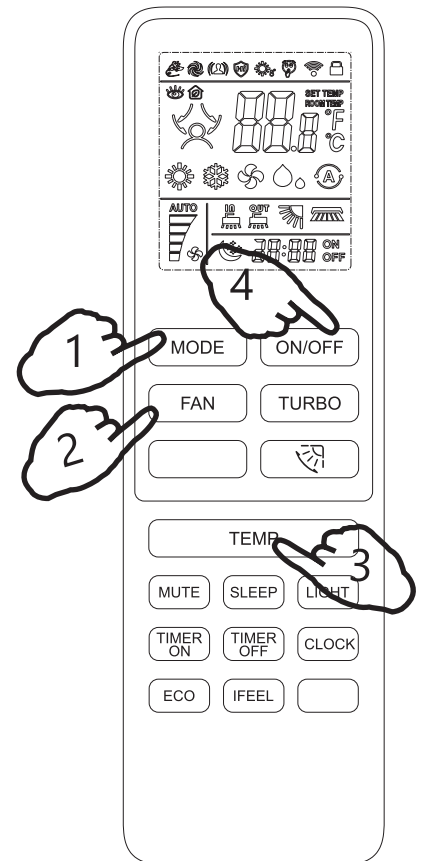

SWING, SMART, TIMER ON, TIMER OFF, CLOCK, SLEEP, will be specified in the following pages.

- ☑ • Changing modes during operation, sometimes the unit does not response at once. Wait 3 minutes.
- During heating operation, air flow is not discharged at the beginning. After 2-5 minutes, the air flow will be discharged until temperature of indoor heat exchanger rises.
- Wait 3 minutes before restarting the appliance.

Operation instructions

Airflow direction control

Airflow direction control

Vertical airflow (Horizontal airflow) is automatically adjusted to a certain angle in accordance with the operation mode after turning on the unit.

Operation mode	Direction of airflow
COOLING, DRY	horizontal
*HEATING, FAN ONLY	downward

The direction of airflow can be also adjusted to your own requirement by pressing the "SWING" button of the remote controller.



5

*Heating mode is only available for heat pump models.

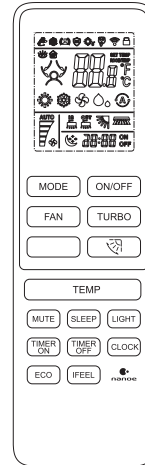

Vertical airflow control (with the remote controller)

Using remote controller to set various angles of flow or specific angle as you like.

Swinging airflow

Pressing  button once, the vertical adjustment louver will swing up and down automatically.

Desired direction airflow

Pressing the  button again when the louvers swing to a suitable angle as desired.

- A** Do not turn the vertical adjustment louvers manually, otherwise malfunction may occur. If that happens, turn off the unit first and cut off the power supply, then restore power supply again.
- B** It is better not to let the vertical adjustment louver tilt downward for a long time at COOLING or DRY mode to prevent condensed water from dripping.

Operation instructions

CLOCK button

You can adjust the real time by pressing CLOCK button, then using “+” and “-” buttons to get the correct time, press CLOCK button again the real time is set.

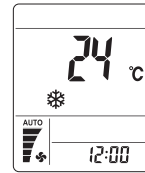

Timer mode

It is convenient to set the timer on with **TIMER ON** button when you go out in the morning to achieve a comfortable room temperature at the time you get home. You can also set timer off at night to enjoy a good sleep.

► How to set **TIMER ON**

TIMER ON button can be used to set the timer programming as wished in order to switch on the appliance at your desired time.

- i) Press TIMER ON button, "ON 12:00" flashes on the LCD, then you can press the “+” or “-” buttons to select your desired time for appliance on.

Increase

Decrease

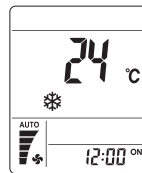

Press the “+” or “-” button once to increase or decrease the time setting by 1 minute.

Press the “+” or “-” button 2 seconds to increase or decrease the time setting by 10 minutes.

Press the “+” or “-” button for a longer time to increase or decrease the time by 1 hour.

Note: If you don't set the time in 10 seconds after you press **TIMER ON button, the remote controller will exit the **TIMER ON** mode automatically.**

- ii) When your desired time displayed on LCD, press the **TIMER ON** button and confirm it. **"ON" stops flashing.**
*The **TIMER** indicator on the indoor unit lights up.*

- iii) After the set timer displayed for 5 seconds the clock will be displayed on the LCD of the remote controller instead of set timer.

► How to cancel **TIMER ON**

Press the **TIMER ON** button again, the indicator disappears, the **TIMER ON** mode has been canceled.

Note: It is similar to set **TIMER OFF, you can make the appliance switch off automatically at your desired time.**

Operation instructions

SLEEP mode

SLEEP mode

SLEEP mode can be set in **COOLING, HEATING or DRYING** operation mode.

This function gives you a more comfortable environment for sleep.

In **SLEEP** mode,

- The appliance will stop operation automatically after operating for 8 hours.
- Fan speed is automatically set at low speed.

- *Set temperature will rise by 1°C at most if the appliance operates in cooling mode for 1 hour constantly, then keeps steady.
- Set temperature will decrease by 3°C at most if the appliance operates in heating mode for 3 hours constantly, then keeps steady.

For some models, such as G1Q series

- *Set temperature will rise by 2°C at most if the appliance operates in cooling mode for 2 hour constantly, then keeps steady.
- Set temperature will decrease by 2°C at most if the appliance operates in heating mode for 2 hours constantly, then keeps steady.

**Note: In cooling mode, if room temperature is 26°C or above, set temperature will not change.*

Note: Heating is NOT available for cooling only air conditioner.

Note: Press TURBO, ON/OFF, FAN, MODE, ECO or SLEEP button cancel SLEEP mode.

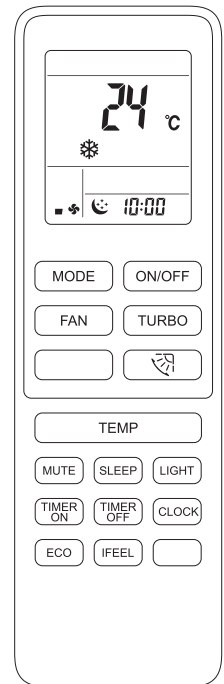

Turbo mode

TURBO mode

TURBO mode is used to start or stop fast cooling when the unit is on.

TURBO mode can be set when the appliance is in operation or energized.

In **TURBO** mode, you can set airflow direction or timer.

◆ How to set **TURBO** mode?

Press **TURBO** button at the cooling, fan only or dry mode.

Result: At high fan speed, the set temperature automatically to 16°C.

Press **TURBO** button at the heating mode.

Result: At **AUTO** fan speed, the set temperature automatically to 30°C.

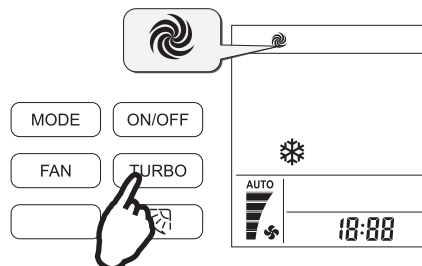

◆ How to cancel **TURBO** mode?

Press **TURBO, MODE, FAN, ON/OFF, SLEEP, TURBO** or **MUTE** button.

Result: The display return to the original mode.
Escape from **TURBO** mode.

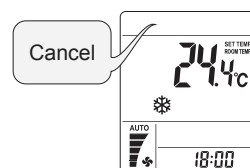

Operation instructions

8°C HEAT mode

8°C HEAT mode

In HEATING mode, Press and buttons together for 3 seconds to start 8°C HEAT mode. In 8°C HEAT mode, the fan speed is set at “AUTO” automatically. The icon will appear on the LCD.

If pressing any button, other than ON TIMER, OFF TIMER, DIMMER, IFEEL and SWING, 8°C HEAT function will be turned off. And the icon will disappear.

Note:

In 8°C HEAT mode, the default temperature is set 8°C.

8°C HEAT mode can be set only when the air conditioner works in HEATING mode.

Only for models with 8°C HEAT function.

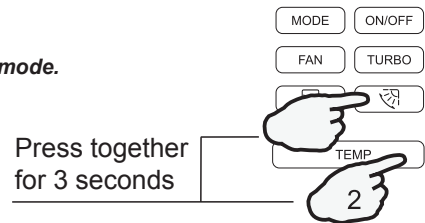

LOCK function

LOCK function

- **TIME ON** and **TIME OFF** buttons together for 3 seconds to start **LOCK** function.

The icon will appears on the LCD.

- **TIME ON** and **TIME OFF** buttons together for 3 seconds again to stop **LOCK** function.

The icon will disappeared from the LCD

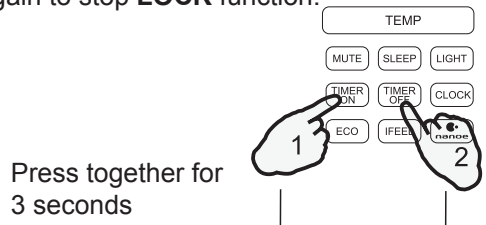

Operation instructions

MUTE mode

MUTE mode

In this mode, the air conditioner will work with low noise performance.
In this mode, you can start the SLEEP mode at the same time.



Note:

- * MUTE button is only available in COOLING, HEATING and FAN ONLY mode.
- * Press MODE, FAN SPEED, SMART or SUPER button to cancel MUTE mode.

ECO mode

ECO mode

In this mode, the air conditioner will bring you energy saving performance by lower running currency.

Note:

- * ECONOMY button is ineffective in SMART and SUPER mode.
- * SMART and SUPER buttons are not available in ECONOMY mode.
- * Press ON/OFF, MODE, TEMP ±, FAN SPEED, SLEEP, QUIET or ECONOMY button to cancel ECONOMY mode.



IFEEL function

IFEEL function

The temperature sensor built in remote controller is activated. It can sense its surrounding temperature, and transmit the signal back the unit, the unit can adjust the temperature so as to provide maximum comfort.



Note:

- Advice to put the remote controller in the place where the indoor unit receive signal easily.
- Advice to cancel the IFEEL mode so as to save energy when stopping the air conditioner.

Quick Start Guide

Follow these four easy steps to set up your appliance

① Install the appliance and turn it on.



ConnectLife

② Open Android Play Store or IOS App Store in your smart phone, then enter “ConnectLife” in the Search bar to find the latest version. Download and install it.

③ Follow WiFi instruction to pair with your appliance.

④ Manage and enjoy complete control over your appliance.



QR Code for Android



QR Code for iOS

dzitsu

EUROFRED
being efficient

Eurofred S.A.
Marqués de Sentmenat 97
08029 Barcelona
www.eurofred.es