

REMOTE CONTROLLER (WIRED TYPE) OPERATING MANUAL

PART No. 9373329657 (En)
[Original instructions]

Keep this manual for future reference.

UTY-RCRYZ1
UTY-RCRGZ1
UTY-RCRXZ1
UTY-RCRGZ1K

Refer to the rating label for the serial number,
manufactured year and month.

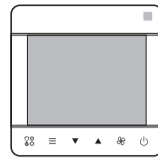

MADE IN CHINA

SAFETY PRECAUTIONS

- To prevent personal injury, or property damage, read this section carefully before you use this unit, and be sure to comply with the following safety precautions.

WARNING	This mark indicates procedures which, if improperly performed, might lead to the death or serious injury of the user.
<ul style="list-style-type: none"> In the event of a malfunction (burning smell, etc.), immediately stop operation, turn off the electrical breaker, and consult authorized service personnel. Do not repair or modify any damaged cable by yourself. Let the authorized service personnel to do it. Improper work will cause an electric shock or a fire. When moving, consult authorized service personnel for uninstallation and installation of this unit. Do not touch with wet hands. It may cause an electric shock. If children may approach the unit, take preventive measures so that they cannot reach the unit. 	<ul style="list-style-type: none"> Do not repair or modify by yourself. It may cause a fault or accident. Do not use flammable gas near this unit. It may cause a fire from leaking gas. This appliance is not intended for use by persons (including children) with reduced physical, sensory or mental capabilities, or lack of experience and knowledge, unless they have been given supervision or instruction concerning use of the appliance by a person responsible for their safety. Children should be supervised to ensure that they do not play with the appliance.

CAUTION	This mark indicates procedures which, if improperly performed, might possibly result in personal harm to the user, or damage to property.
<ul style="list-style-type: none"> Do not set vessels containing a liquid on this unit. Doing so will cause heating, fire, or electric shock. Do not expose this unit directly to water. Doing so will cause trouble, electric shock, or heating. Dispose of the packing materials safely. Tear and dispose of the plastic packing bags so that children cannot play with them. There is the danger of suffocation if children play with the original plastic bags. 	<ul style="list-style-type: none"> Do not place electrical devices within 1 m of this unit. It may cause malfunction or failure. Do not use fire near this unit or place a heating apparatus nearby. It may cause malfunction. Do not touch the switches with sharp objects. Doing so will cause injury, trouble, or electric shock.

OPERATING TIPS

Cooling / Heating priority
(Heat pump model only)

- If another indoor unit in the same system is already operating in the cooling mode or dry mode, heating mode settings cannot be performed.
- An indoor unit that is set up as an Administrative indoor unit can operate in the auto mode.
- Administrative indoor unit:
Administrative indoor unit has priority for cooling and heating configurations.

TROUBLE SHOOTING

Before requesting service, perform the following checks:

Symptom	Problem
Doesn't operate at all.	<ul style="list-style-type: none"> Has there been a power failure? Has the indoor unit electrical breaker been cut off?
	<ul style="list-style-type: none"> It is being controlled centralized?

If the problem persists after performing these checks, or if you notice burning smells, or the LED lamp flashes, immediately stop operation, turn off the electrical breaker and consult authorized service personnel.

SPECIFICATIONS

Model Name		UTY-RCRYZ1 UTY-RCRGZ1 UTY-RCRXZ1 UTY-RCRGZ1K
Input voltage		DC 12 V
Dimensions & Weight	Height	86 mm
	Width	86 mm
	Depth	44 mm
	Weight	135 g
Manufacturer		FUJITSU GENERAL LIMITED 3-3-17, Suenaga, Takatsu-ku, Kawasaki 213-8502, Japan

FUJITSU GENERAL LIMITED
3-3-17, Suenaga, Takatsu-ku, Kawasaki 213-8502, Japan

OPERATION

OPERATION MODE

Touch [] button to select the operation mode while in operation.



- * A heat pump model that is not set up as an Administrative indoor unit cannot operate in the auto modes.
- ** Fan cannot be selected for a heat pump model.
- *** Heating operation cannot be performed in the "Cooling-only" models.

- If the priority mode is set to "Priority on Administrative indoor unit", the operating mode of other indoor units except Administrative indoor unit will be controlled by an Administrative indoor unit.
- If the operating mode of Administrative indoor unit is set to "AUTO", "AUTO" is displayed in addition to the indicator of current operating mode on other wired remote controllers except Administrative indoor unit. In this case, operation of other indoor units is controlled by the Administrative indoor unit.

Ex.: When operating mode of the Administrative indoor unit is set to "AUTO" while air conditioning setting. (The indication on other wired remote controllers except Administrative indoor unit).

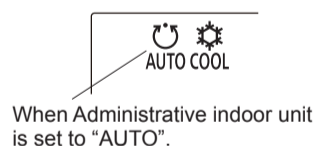

MENU OPERATION

- Every time when [] button is touched, the setting screen changes in the following order.

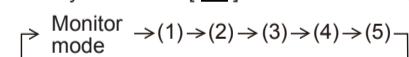

- After configuring each setting, touch this button again to confirm the setting. If no action is made for 3 seconds, the setting is confirmed as well. After setting, touch this button several times to return to monitor mode.
- A setting screen is not displayed if the indoor unit does not have the corresponding setting or if the function is limited by the central controller.

- Comfort airflow setting
"COMFORT" flashes. Touch [] or [] to specify whether the comfort airflow is enabled or not. When the comfort airflow setting is enabled, the "COMFORT" is displayed on the monitor screen.
- Horizontal airflow direction setting
Touch [] or [] button to set the angle of horizontal airflow direction. When the horizontal airflow direction setting is enabled, the setting state is displayed on the monitor screen.
- Vertical airflow direction setting
Touch [] or [] button to set the angle of vertical airflow direction. When the vertical airflow direction setting is enabled, the setting state is displayed on the monitor screen.
- OFF Timer setting
"OFF" is flashes. Touch [] or [] button to set the timer [0.0h (Release)/ 0.5h/1.0h/ 2.0h/ 3.0h/6.0h/12h]. When the OFF Timer setting is enabled, "OFF" is displayed on the monitor screen.
- Filter sign reset
"Filter" is flashes. Touch [] or [] button to display "CANCEL". The Filter sign is reset after three seconds, and "Filter" is cleared.

Instructions on heating are not applicable for the "Cooling-only" models.

Wireless remote controller signal receiving section

The wireless remote controller can be used to operate the indoor unit. The following operations can be done:

- Start/Stop
- Fan speed
- Temperature
- Operation mode
- Horizontal airflow direction
- Vertical airflow direction
- Filter sign reset

START / STOP

Each press of [] button alternates operation and stop. When operating, " " will light up.

FAN SPEED

Touch [] button to select the fan speed. (The available fan speed differs depending on the type of indoor unit.)

TEMPERATURE

Touch [] or [] button to set the temperature. (The temperature setting should be considered a standard value, and may differ somewhat from the actual room temperature.)

: Room temperature, : Set temperature
Temperature setting range

COOL/DRY/AUTO*	18 to 30 °C (64 to 88 °F) or 20 to 30 °C (68 to 88 °F)
HEAT	VRF system: 10 to 30 °C (48 to 88 °F) Other system: 16 to 30 °C (60 to 88 °F)

* The lower limit of the setting temperature is different depending on the place of use.

Notes:

- " " is displayed if there is an error. Stop operation immediately and contact authorized service personnel.
- When a button is touched to change a restricted setting, " " will flash. When " " is displayed, this operation cannot be set or changed.
- When " " is displayed, the air conditioner might not sufficiently cool the room in cooling mode, or sufficiently heat the room in heating mode.
- If " " does not turn off after a while, contact authorized service personnel.
- The operations not available on the indoor unit cannot be set.
- " " is displayed when operation of the air conditioner has stopped due to an emergency.
- " " is displayed when the air conditioner is in test run.

Operation Flow (when operating the indoor unit equipped with the comfort airflow function)

Monitor Screen (during operation)

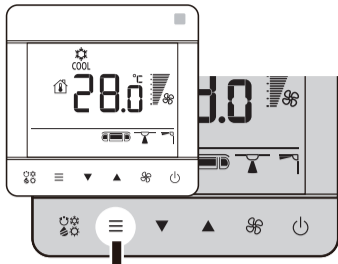

* For the indoor unit not equipped with the comfort airflow function, "COMFORT" will not be displayed.

Operation Menu Items

- : Proceeds to the next menu. Confirms the selected setting.
- : Selects an item.
- After completing the setting, press several times to return to the monitor screen.
- If no action is made for 10 minutes, the screen returns to the monitor screen.
- A setting screen is not displayed if the indoor unit does not have the corresponding setting or if the function is limited by the central controller.

1 Comfort airflow setting

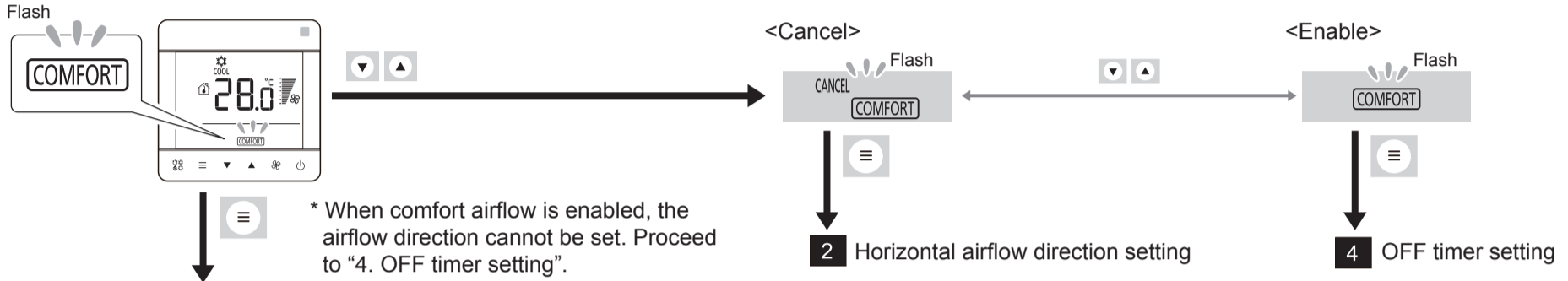

2 Horizontal airflow direction setting

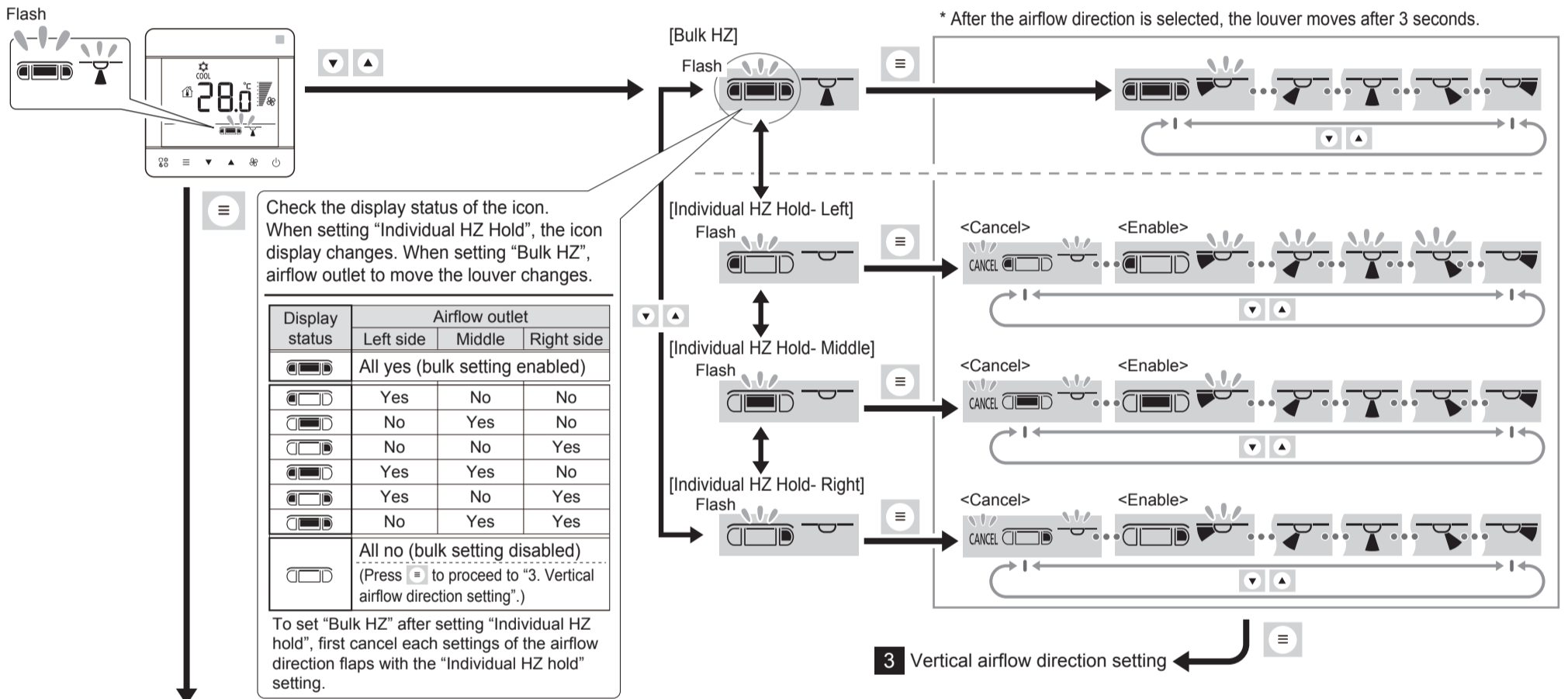

3 Vertical airflow direction setting



4 OFF timer setting

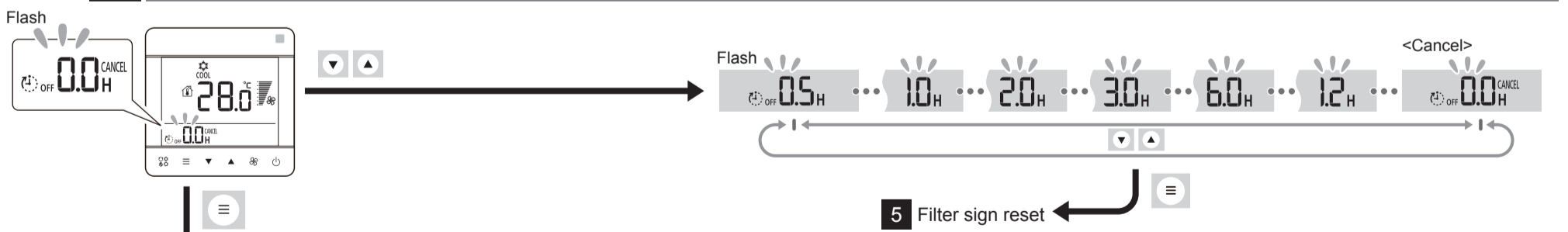

5 Filter sign reset

